

MEMORANDUM

DATE: October 5, 2021

TO: Mayor & City Council
CC: Mercy Rushing, City Manager

FROM: David Madsen

SUBJECT: **Council Meeting Agenda Item:** Guy Street name change

Background Information: As you know ETCOG manages our 911 addressing data base and helps keep us in compliance with state addressing standards. We get notified when an issue is found that could pose a problem to first responders. This usually occurs when a new address is assigned to a location or it is reported to them as we find them while out in the field. When a new address is assigned or one is changed, a five hundred foot area is looked at around the location to see if there are any other problems. A new address is being requested on Guy Street and so an issue was noticed during this process. The problem is that Guy Street is in two separate locations and both location have the same address ranges. The sections are not connected although an older map of the city shows a proposed connection that was never made and never will be because there is no right of way at that location. At this time there is only one physical address for each of the Guy Street sections. 410 and 419. 410 is vacant and 419 has a house located on it. Other addresses will eventually be assigned as lots sell and houses are built or moved in. This will more than likely be a problem to first responders as new personnel come in and EMS crews from different areas respond in Mineola.

Recommendation: Staff recommends changing a section of Guy Street to another name.

Final Disposition:

Wood CAD Web Map

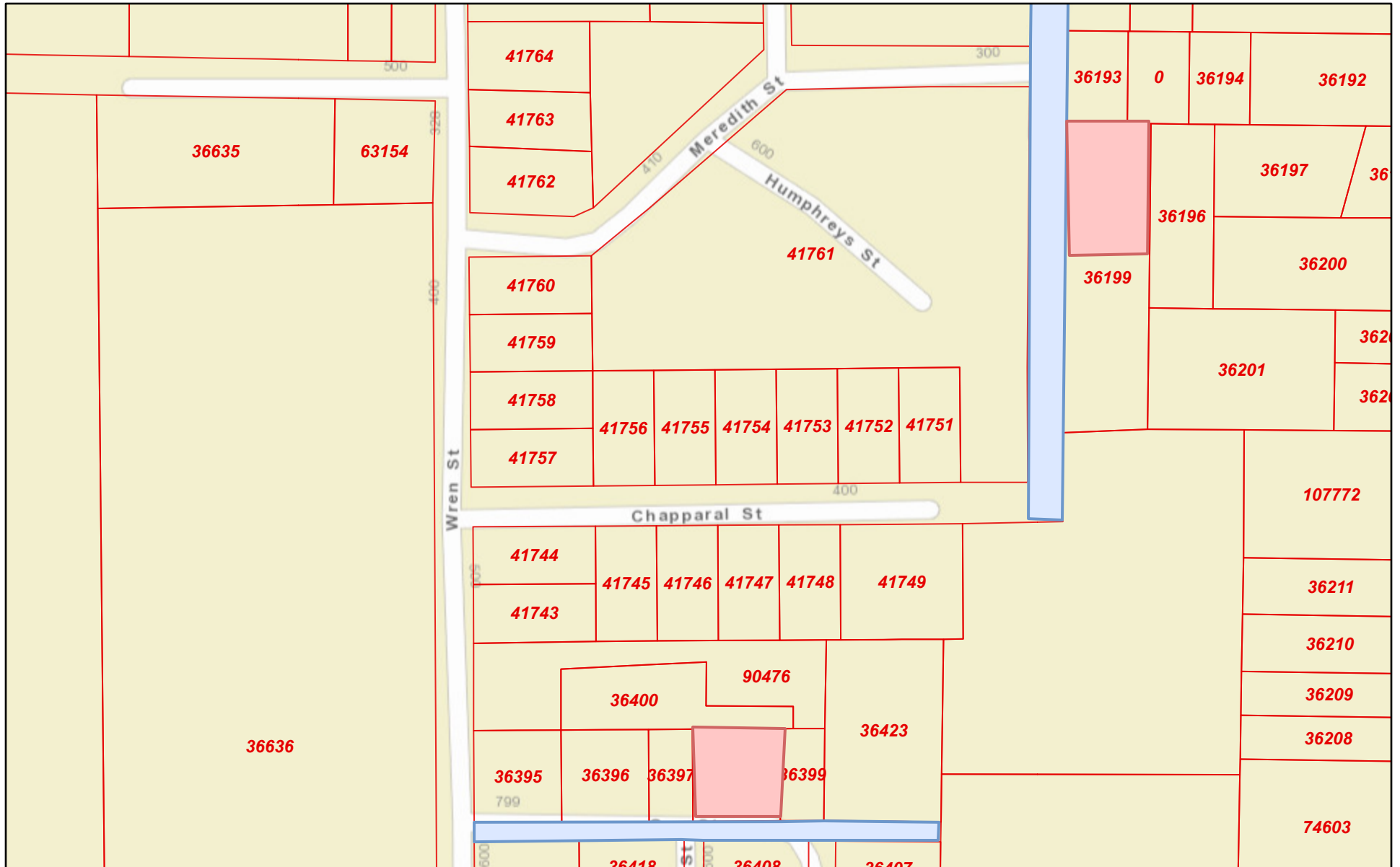

10/5/2021, 2:36:49 PM

 Parcels

1:2,257

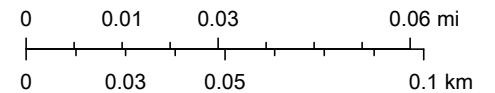

Esri, HERE, Garmin, INCREMENT P, NGA, USGS

Wood County Appraisal District, BIS Consulting - www.bisconsulting.com

Disclaimer: This product is for informational purposes only and has not been prepared for or be suitable for legal, engineering, or surveying purposes. It does not represent an on-the-ground survey and represents only the approximate relative location of boundaries.

Wood CAD Web Map

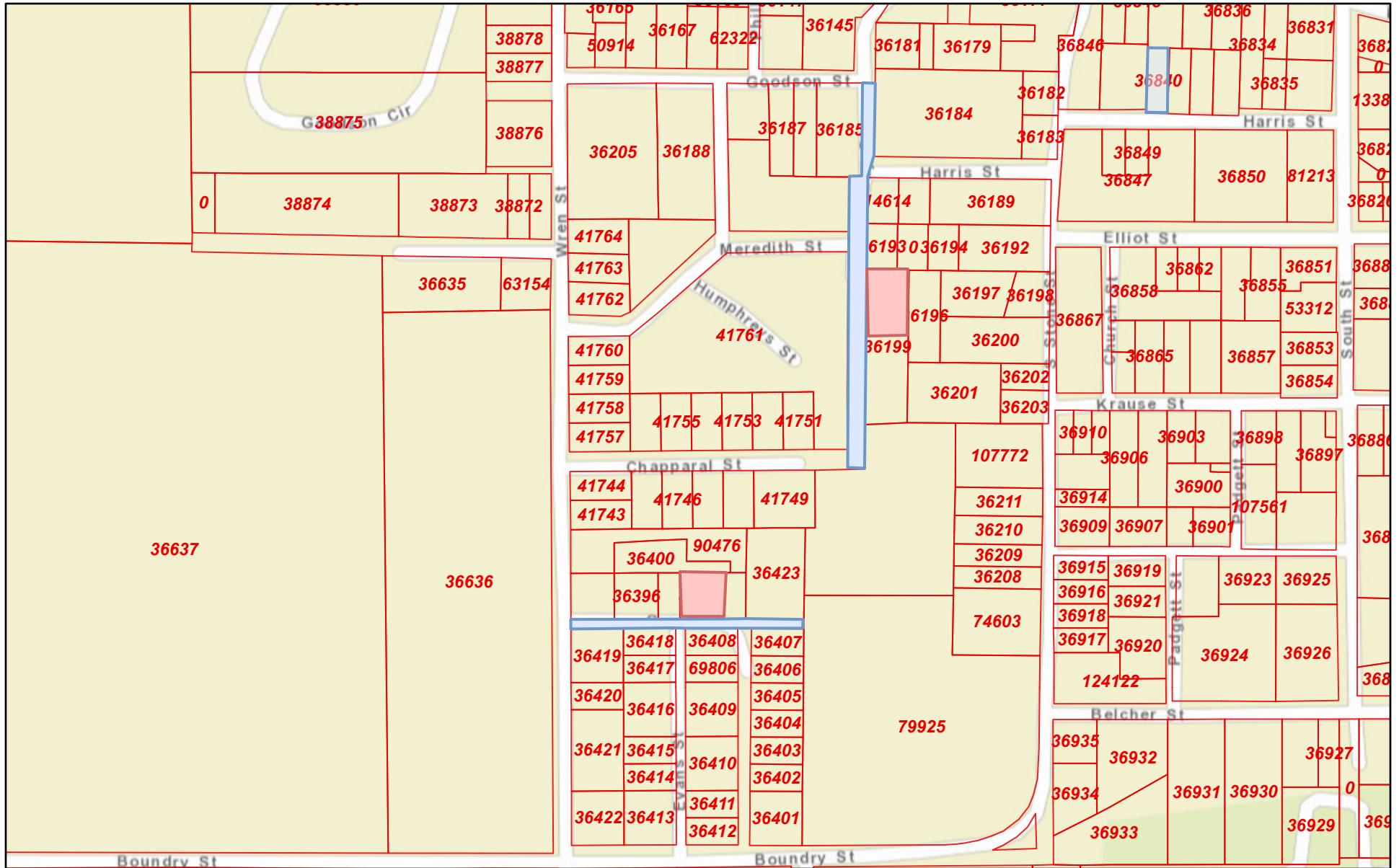

10/5/2021, 2:57:13 PM

 Parcels

1:4,514

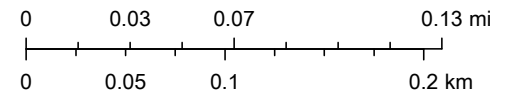

Esri, HERE, Garmin, INCREMENT P, NGA, USGS

Wood County Appraisal District, BIS Consulting - www.bisconsulting.com

Disclaimer: This product is for informational purposes only and has not been prepared for or be suitable for legal, engineering, or surveying purposes. It does not represent an on-the-ground survey and represents only the approximate relative location of boundaries.

Wood CAD Web Map

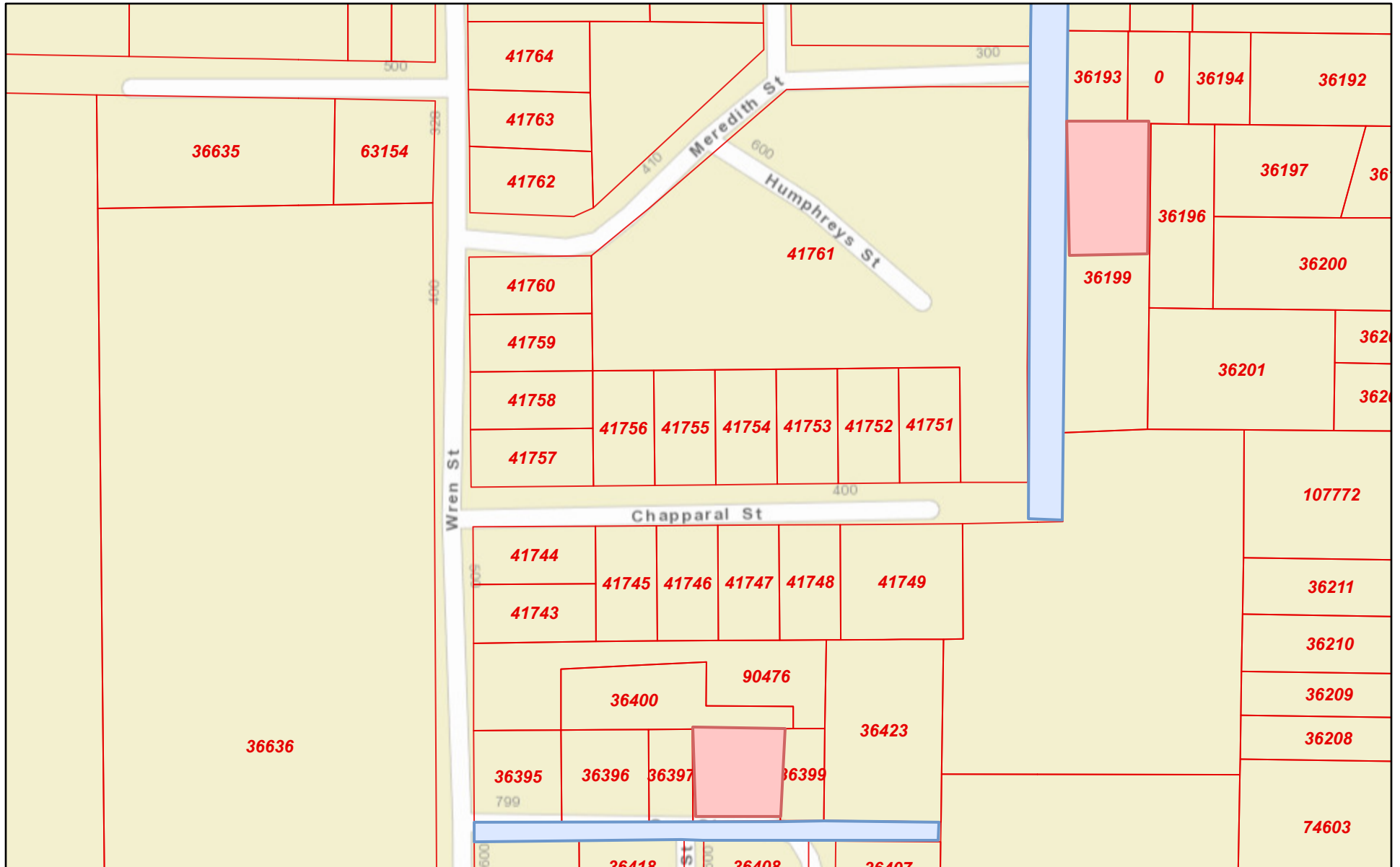

10/5/2021, 2:36:49 PM

 Parcels

1:2,257

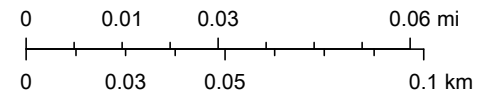

Esri, HERE, Garmin, INCREMENT P, NGA, USGS

Wood County Appraisal District, BIS Consulting - www.bisconsulting.com

Disclaimer: This product is for informational purposes only and has not been prepared for or be suitable for legal, engineering, or surveying purposes. It does not represent an on-the-ground survey and represents only the approximate relative location of boundaries.

Wood CAD Web Map

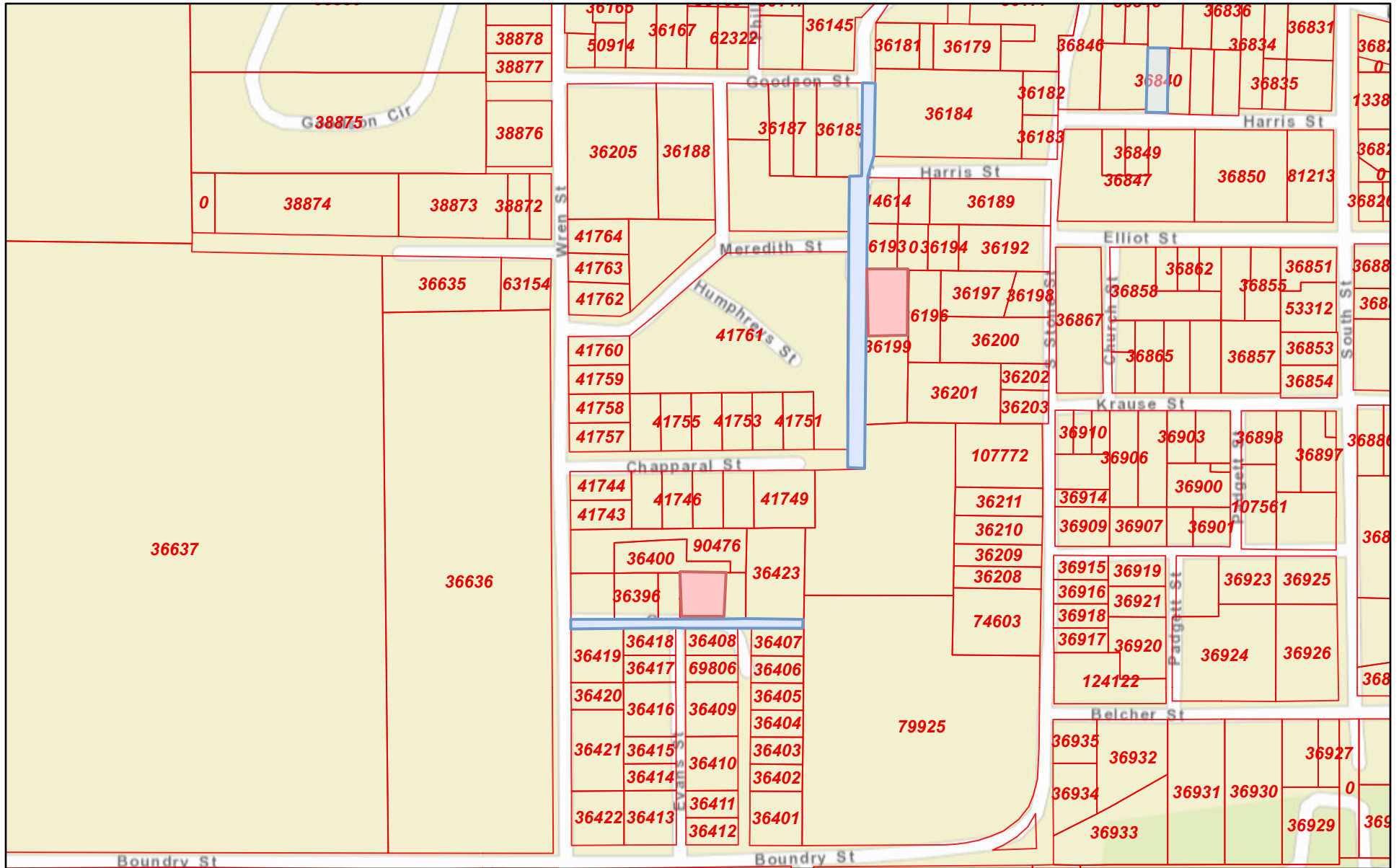

10/5/2021, 2:57:13 PM

 Parcels

1:4,514

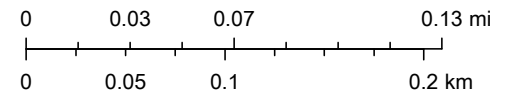

Esri, HERE, Garmin, INCREMENT P, NGA, USGS

Wood County Appraisal District, BIS Consulting - www.bisconsulting.com

Disclaimer: This product is for informational purposes only and has not been prepared for or be suitable for legal, engineering, or surveying purposes. It does not represent an on-the-ground survey and represents only the approximate relative location of boundaries.